

REMODEL USAGE MAP

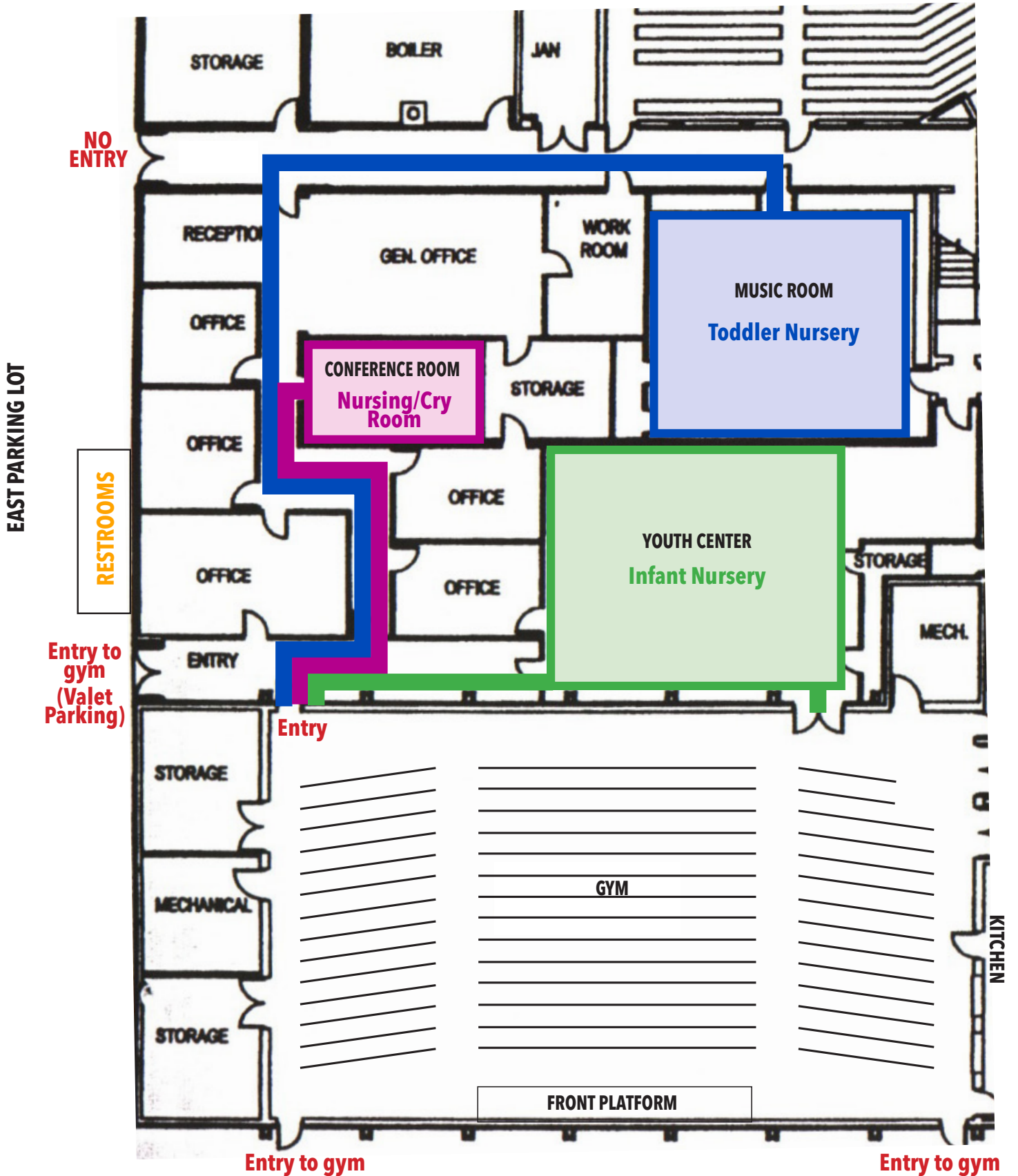

*Coffee time will be located in outer narthex from April 23-May 7; following that, coffee time will be outdoors.

* Restrooms in outer narthex will be available through May 7; following that, restrooms will be located in east parking lot.

CHURCH REMODEL: IMPORTANT INFORMATION

Over the next several months during our church remodel, there will be lots of changes occurring in our church building. To make this transition time a little more manageable, we've put together a timeline to inform you about some of the major disruptions, closures, re-locations, etc. All this is an attempt to give you as much information as we can so that the chaos can be a bit more contained. Please keep in mind that we will be worshiping in a construction zone, so please be patient with the dust and all that comes with a project of this scope. We encourage everyone to adopt an attitude of flexibility, as some things may change in the course of the project – we know that things may not always go as planned, and adjustments may need to be made in the plan and schedule. It's important to keep in mind the end goal of the project: that God will be glorified through our efforts.

Sunday, April 16:

- Final Sunday in our current sanctuary.

Sunday, April 23 – Sunday, May 7:

- Worship services will be held in the gym
- Entrances will be available at the (1) north canopy doors, (2) east entry (one door down from main office door), and (3) the two north doors on either end of the gym.
- Nurseries will relocate:
 - Toddler nursery will be located in the music room.
***Access to this space will be through the back hallway behind the gym, through the church office, and to the hallway down to the music room.*
 - Infant nursery will be located in the youth center.
 - A nursing area and cry room will be available in the office conference room.
- Children's Church will meet in Room E/F (April 23–May 14).
- Choir will meet in the preschool - Room 101/103.
- The outer narthex and existing restrooms in that area will be open and available for use.
- Temporary restroom facilities will be located in the east parking lot.
- Sunday coffee time will be held in the outer narthex. People may also feel free to enjoy their coffee outdoors, weather permitting.
- The doors between the inner and outer narthex will be closed. The area from the inner narthex through the sanctuary will be inaccessible. No persons will be permitted in that area.
- The classroom area (Rooms A–H) will be available and accessible by walking from the outer narthex through the preschool.
- The preschool education wing on the second floor will be accessible as usual.
- Church offices will be open as usual during the week, Monday–Friday.

Sunday, May 14 – Early December ?

- Outer narthex will be closed. The restrooms in the outer narthex will not be accessible. Available restroom facilities are located in the east parking lot. These facilities will be wheelchair accessible.
- Sunday coffee time will be held outdoors.
- Mailslots will be unavailable. The Information Center will be relocated to the gym.
- No entry to the church will be available under the canopy. That area will be blocked off for construction and staging.
- Valet parking will be available at the east entry door.
- Children's Church will not meet during the summer months.
- Church offices will be open as usual during the week, Monday–Friday.